

US Echo II

Ultrasonic Flow Meter Qp 0.6-15 m³/h

US ECHO II is the standard for highly accurate flow meters. Issued from CF Heat Meter's family, US ECHO II easily adapts its self to different types of calculators. Its powerful electronics enables any user to take advantage of all state of the art functions maintaining an extraordinary high precision throughout the entire measurement curve.

Flows are measured from 6 L/h up to 33 m³/h for different piping going from DN15 up DN50. All flows exist for PN25 applications.

FEATURES AND BENEFITS

- » High Accuracy
- » Robustness
- » Ease of Installation
- » Self Management
- » Repeatability over time
- » Robustness
- » Reliability
- » Diagnostic functions

CE type approval certificate:
DE-06-MI004-PTB008

Applications

Heating and/or cooling installations for horizontal or vertical mounting.

Standards Compliance

- » MID 2004/22/EC Module B+D
- » Class 2.0 acc. EN 1434
- » Env. Class C acc. EN 1434
- » PTB approved
- » PED compliance

DIMENSIONS

See Technical Characteristics table for available lengths.

DN	15	20	25	32	40	50
A	72	72	77	77	85	85
B	18	18	23	24	35	-
Dø (flanges)	-	100	100	-	140	160

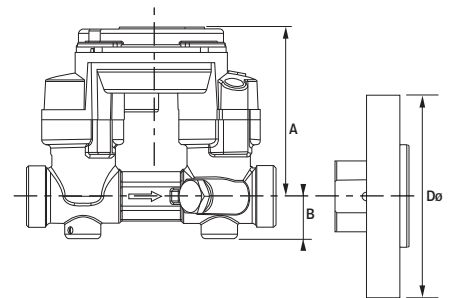

HEAD LOSS

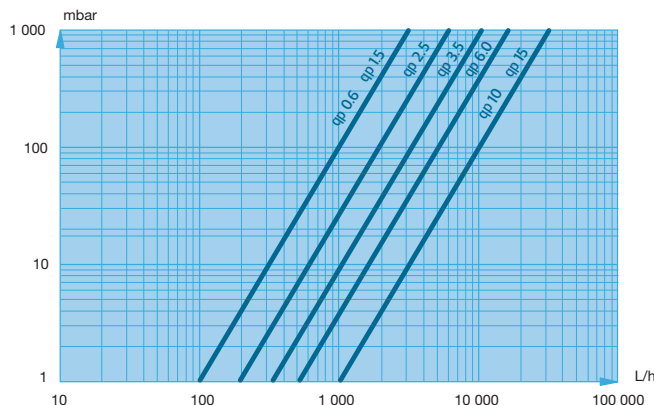

Technical Characteristics

Nominal Flow Qp m ³ /h	Diameter DN mm	Max flow Qs m ³ /h	Min flow Qs L/h	Start flow Qstart L/h	Body length mm	Pipe Connection	Nominal Pressure bar	Permanent max. temp. °C	Accidental max. temp. °C
0.6	15	1.2	6	1.2	110	G ¾ B	16/25	130	150
	20	1.2	6	1.2	130	G 1 B	16/25	130	150
	20	1.2	6	1.2	190	G 1 B / flanges	16/25	130	150
1.5	15	3	15	3	110	G ¾ B	16/25	130	150
	20	3	15	3	130	G 1 B	16/25	130	150
	20	3	15	3	190	G 1 B / flanges	16/25	130	150
2.5	20	5	25	5	130	G 1 B	16/25	130	150
	20	5	25	5	190	G 1 B / flanges	16/25	130	150
	25	5	25	5	260	G 1 ¼ B	16/25	130	150
3.5	25	7	35	7	150	G 1 ¼ B	16/25	130	150
	25	7	35	7	260	G 1 ¼ B / flanges	16/25	130	150
	40	7	35	7	300	Flanges	25	130	150
6	25	12	60	12	150	G 1 ¼ B	16/25	130	150
	25	12	60	12	260	G 1 ¼ B / flanges	16/25	130	150
	32	12	60	12	260	G 1 ½ B	16/25	130	150
	40	12	60	12	300	Flanges	25	130	150
	50	12	60	12	270	Flanges	25	130	150
10	40	20	100	20	200	G 2 B	16/25	130	150
	40	20	100	20	250	Flanges	25	130	150
	40	20	100	20	300	G 2 B / flanges	16/25	130	150
	50	20	100	20	270	Flanges	25	130	150
15	50	30	150	30	250	Flanges	25	130	150
	50	30	150	30	270	Flanges	25	130	150

Pulse Value (Qp)	Pulses (L/p)	Test Pulses (cm ³ /p)
0.6	1, 2.5, 10, 25, 100, 250	5
1.5	1, 2.5, 10, 25, 100, 250	10
2.5	1, 2.5, 10, 25, 100, 250	20
3.5	1, 2.5, 10, 25, 100, 250	25
6	1, 2.5, 10, 25, 100, 250	50
10	1, 2.5, 10, 25, 100, 250	100
15	1, 2.5, 10, 25, 100, 250	100



Our company is the world's leading provider of smart metering, data collection and utility software systems, with over 8,000 utilities worldwide relying on our technology to optimize the delivery and use of energy and water.

To realize your smarter energy and water future, start here: www.itron.com

ESSCO CONTROLS LIMITED

UNIT 11 SOLENT INDUSTRIAL ESTATE, SHAMBLEHURST LANE SOUTH

HEDGE END, SOUTHAMPTON. SO30 2FX

TEL: 01489 779068 FAX: 01489 779069