



FIGURE 85 - WRAS APPROVED FULL BORE BRASS BALL VALVE 1/4" - 2"



Features and Specifications:

- * **Hot forged** sand blasted, nickel plated body and cap sealed with Loctite,
- * **Approved** by The Australian Gas Association (AUS), WRAS (UK),
- * Finest brass according to **EN 12165** and **EN 12164** (formerly DIN 17660 and UNI 5705-65) specifications,
- * **Full port** to DIN 3357 for maximum flow,
- * **24h 100%** seal test guaranteed,
- * Pure **PTFE** self-lubricating seats with flexible-lip design,
- * Dual sealing system allows valve to be operated in either direction making **installation easier**,
- * Chrome plated brass ball for **longer life**,
- * **No metal-to-metal** moving parts,
- * **Blowout-proof** nickel plated brass stem,
- * Pure PTFE **adjustable packing gland** and washer for lower torque and easy maintenance,
- * Handle stops on body to **avoid stresses** at stem,
- * **Geomet®** carbon steel handle with thick PVC dip coating,
- * Handle clearly shows ball position,

- * **DIN 2999, ISO 228** parallel Female by Female threads,
- * **Silicone-free** lubricant on all seals,
- * 40 bar (Kg/cm²) non-shock cold water **pressure**,
- * -40°C +170°C **temperature** (Warning: freezing of the fluid in the installation may severely damage the valve).

Options:

- * Stem **extension**,
- * **T-handle**,
- * **Oval lockable handle**,
- * AISI 430 **stainless steel handle**,
- * Patented **locking device**.

Upon request:

- * AISI 316 **stainless steel ball and/or stem**,
- * **Glass filled** PTFE seals,
- * Custom design.

NOTE: Approvals apply to specific configurations only.

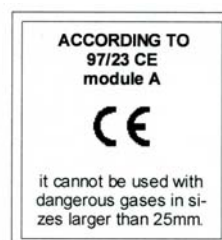
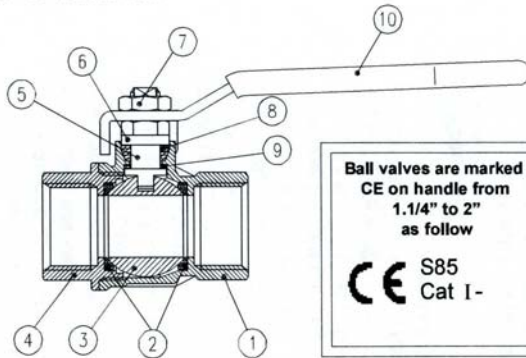



FIGURE 85 - WRAS APPROVED FULL BORE BRASS BALL VALVE 1/4" - 2"

1.1/4"-2" hollow ball



Ball valves are marked
CE on handle from
1.1/4" to 2"
as follow

CE S85
Cat I-

PART DESCRIPTION	Q.ty	Material
1 Nickel plated body	1	CW617N
2 Seat	2	Ptfe
3 Chrome plated ball	1	CW617N
4 Nickel plated end cap	1	CW617N
5 Nickel plated stem packing gland design	1	CW617N
6 Nickel plated gland nut	1	CW617N
7 Geomet® nut	1	CB4FF
8 Packing gland seal	1	Ptfe
9 Washer	1	Ptfe
10 Black Geomet® steel handle	1	DD11

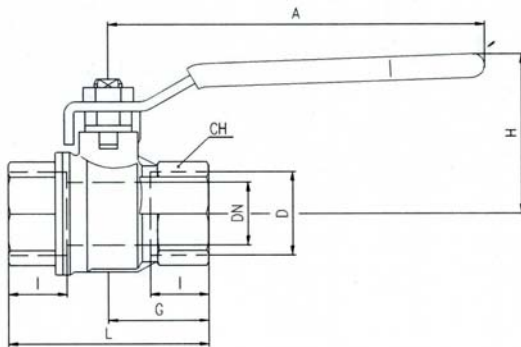

Code	S85B01	S85C01	S85D01	S85E01	S85F01	S85G01	S85H01	S85I01
D (Inch)	1/4	3/8	1/2	3/4	1	1 1/4	1 1/2	2
DN(mm)	8	10	15	20	25	32	40	50
I (mm)	12	12	15.5	17	21	23	23	26.5
L (mm)	45	45	59	64	81	93	102	121
G (mm)	22.5	22.5	29.5	32	40.5	46.5	51	60.5
A (mm)	82	82	100	120	120	158	158	158
H (mm)	39.5	39.5	43	50.5	54.5	76	82	89
CH(mm)	20	20	25	31	40	49	54	68.5

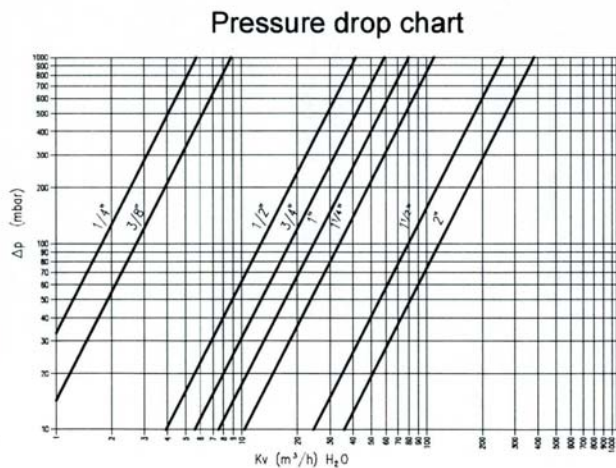
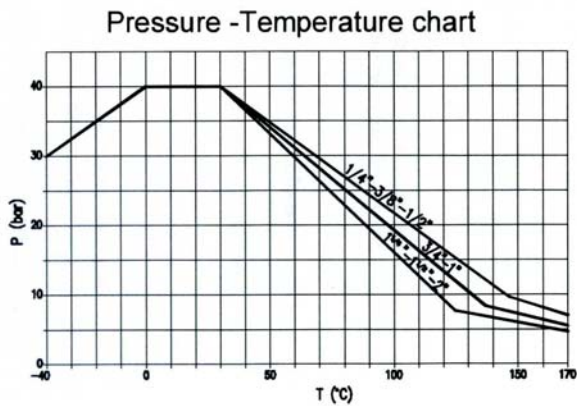

DN shows the nominal flow diameter. Actual flow diameter complies with full port DIN 3357 part 4.